

南區區議會

規劃、工程及房屋事務委員會

赤柱海濱改善工程 - 施工詳情

目的

本文旨在徵詢委員對赤柱海濱改善工程的施工時間表及相關安排的意見。

背景

2. 我們於 2002 年 9 月就促進赤柱旅遊業建議措施諮詢南區議會，其中一項措施乃進行赤柱海濱改善工程。工程的主要部分有美化赤柱大街至八間屋一段海濱長廊沿路的街景，包括重鋪行人徑和行車道、改善街道照明和街道裝置等；在美利樓對開位置興建碼頭；擴展赤柱大街對開的海濱長廊，鞏固海堤和進行相關的改善街貌工程；以及清拆水僊古廟四周的寮屋、美化附近一帶的環境，和改善鄰近八間屋的露天地方。議員對工程計劃表示支持，建築署在深化設計時已考慮了議員的意見。我們亦於 2004 年 1 月就工程的施工時間表及相關安排徵詢黃竹坑及赤柱分區委員會的意見，委員亦對施工時間表及相關安排表示支持。

3. 如獲立法會撥款，赤柱海濱改善工程將於二零零四年年底展開，二零零七年完成。工程計劃將分階段實施，為協調工程計劃各個部分及把工程帶來的不便減至最低，建築署草擬了工程施工時間表及相關安排的資料及施工階段設計圖(見附件)，並會於席上向委員詳細講解。

徵詢意見

4. 請委員就赤柱海濱改善工程的施工詳情發表意見。

經濟發展及勞工局

旅遊事務署

二零零四年三月

**赤柱海濱改善工程
施工時間表及相關的安排**

工程項目	工程對週遭環境的影響
區域一：興建碼頭 (04年11月至07年2月) (註一)	
打樁	工程將以鑽樁的方式進行，所產生的聲浪甚低。工程不會在星期六，星期日及公眾假期進行。
興建碼頭石屎地台	工地將與鄰近的美利樓分隔。工程物料將不會由陸路經美利樓方向進出工地，而是以海路運送，因此不會對陸路交通構成影響及居民造成不便。工程不會在星期六，星期日及公眾假期進行。
興建碼頭上蓋及支柱	工地將與鄰近的美利樓分隔。工程物料將不會由陸路經美利樓方向進出工地，而是以海路運送，因此不會對陸路交通構成影響及居民造成不便。工程所產生的聲浪甚低。
區域二 第一期：擴建海濱長廊 (04年11月至06年9月) (註一)	
填石	工程物料將不會由陸路進出工地，而是以海路運送，因此不會對陸路交通構成影響及居民造成不便。工程不會在行人專用區時段內進行(註二)。
安裝臨時鋼閘板	每天安裝臨時鋼閘板的時間只限數小時。安裝時段將按環境保護署的規定進行。
興建海堤	工程只需少量石屎，因此不會影響陸路交通。工程不會在行人專用區時段內進行。
海濱長廊工程	工程將美化在新造的海堤上興建的海濱長廊。工程不會在行人專用區時段內進行。工程所產生的聲浪甚低。

工程項目	工程對週遭環境的影響
區域二 第二期：美化赤柱大街 (06年10月至07年6月)	
美化赤柱大街	工程將分段進行，施工期間將安排足夠及安全的行人道及行車道，讓行人及車輛安全通行。工程所產生的聲浪甚低。工程不會在行人專用區時段內進行。
區域三 第一期 (i)：重置食環署現有臨時街市 (04年7月至06年2月) (註一)(註三)	
區域三 第一期 (ii)：擴建綠化用地及改善海濱長廊 (05年7月至05年12月)	
擴建綠化用地及改善海濱長廊	施工期間，將安排足夠及安全的行人道，讓行人使用。
區域三 第二期：擴建綠化用地及改善海濱長廊及足球場 (06年1月至06年6月)	
擴建綠化用地及改善海濱長廊及翻新足球場	施工期間，將安排足夠及安全的行人道，讓行人使用。至於足球場，施工期間將會臨時封閉，但會盡量考慮配合舉辦大型活動的需要。
區域四：美化水僊古廟周圍地方 (04年9月至05年7月)	
美化工程	工程所產生的聲浪甚低。
區域五：八間屋 (04年9月至05年7月)	
改善休憩用地	工程所產生的聲浪甚低。

註一： 工程施工期間，工地的範圍將以圍板分隔，以確保行人安全。圍板將繪上彩色圖畫美化，圍板上方亦會設有透明窗口，使遊人可以觀賞海景。

註二： 即星期五晚上 7 時至 11 時，星期六、日、及公眾假期上午 11 時至晚上 11 時。

註三： 有關重建現有臨時街市的工程，食環署已於年前向南區區議會匯報及諮詢，並獲得議會支持。

Southern District Council

Planning, Works and Housing Committee

Stanley Waterfront Improvement Project – Works Arrangements

Purpose

To seek members' views on the construction phasing plan and related arrangements of the Stanley Waterfront Improvement Project (the Project).

Background

2. We consulted the Southern District Council (SDC) on the proposed tourism initiatives for Stanley in September 2002. One of the initiatives is the implementation of the Project. Main components of the Project include streetscape improvements along the waterfront promenade from Stanley Main Street to Pat Kan Uk where pavement and road will be repaved and lighting and street furniture will be enhanced; construction of a pier outside Murray House; extension of the waterfront promenade outside Stanley Main Street and strengthening of the seawall and related streetscape improvement works; clearance of the squatters surrounding Shui Sin Temple and the beautification of the area nearby; and improvements to the open space near Pat Kan Uk. Members of the SDC supported the Project. The Architectural Services Department (ArchSD), in developing its detailed design, has taken into account members' views. We also consulted the Wong Chuk Hang and Stanley Area Committee (AC) in January 2004 on the works phasing plan and related arrangements. Members of the AC supported the plan and arrangements.

3. Subject to funding approval by the Legislative Council, the Project is expected to start in end 2004 for completion in 2007. It will be carried out in phases. For better interface among the different components of the Project and to minimize disturbance, ArchSD has prepared a construction phasing plan and related works arrangements at the **Annex** and would explain in detail to members at the meeting.

Advice Sought

4. Members are invited to comment on the works arrangements.

Tourism Commission

Economic Development and Labour Bureau

March 2004

**Stanley Waterfront Improvement Project
Construction Phasing Plan and Related Arrangement**

Works Items	Impact on the surrounding environment
Area 1: Proposed Pier (Nov. 2004 to Feb. 2007) (Note 1)	
Piling	Pre-bored H-pile will be used during construction. Not much noise will be generated. Works will not be carried out on Saturdays, Sundays and Public Holidays.
Concrete floor slab of the pier	Works site will be separated from the Murray House nearby. Works materials will be delivered to the site by sea, rather than by land transport via Murray House. Therefore, the works will neither have any impact on the land transport nor cause any inconvenience to the public. Works will not be carried out on Saturdays, Sundays and Public Holidays.
Roof and columns of the Pier	Works site will be separated from Murray House nearby. Works materials will be delivered to the site by sea, rather than by land transport via Murray House. Therefore, the works will neither have any impact on the land transport nor cause any inconvenience to the public. Not much noise will be generated.
Area 2 Phase 1: Proposed Boardwalk (Nov. 2004 to Sept. 2006) (Note 1)	
Rock filling	Works materials will be delivered to the site by sea, rather than by land transport. Therefore, works will not cause any impact on land traffic or inconvenience to the public. Work will not be carried out during pedestrianisation hours (Note 2).
Temporary Sheet piling	Works will be carried out for a few hours every day during the construction period. Works will comply with the EPD requirements.

Works Items	Impact on the surrounding environment
Construction of seawall	Works will involve a small amount of concrete. No impact will be caused to land transport. Works will not be carried out during pedestrianisation hours.
Promenade (Boardwalk)	Beautification works of the promenade will be carried out on top of the newly constructed seawall. Works will not be carried out during pedestrianisation hours. Not much noise will be generated.
Area 2 Phase 2: Beautification of Stanley Main Street (Oct. 2006 to June 2007)	
Beautification of Stanley Main Street	Work will be carried by phases. Sufficient and safe pedestrian walkways and vehicular access will be provided during construction. Works will not be carried out during pedestrianisation hours. Not much noise will be generated.
Area 3 Phase 1 (i): Redevelopment of the Stanley Temporary Market (July 2004 to Feb. 2006) (Note 1) (Note 3)	
Area 3 Phase 1 (ii): Proposed Open Space and Promenade (July 2005 to Dec. 2005)	
Proposed Open Space and Promenade	Sufficient and safe pedestrian walkways will be provided during construction.
Area 3 Phase 2: Proposed Open Space and Promenade, Boardwalk, and Soccer Pitch (Jan. 2006 to June 2006)	
Proposed Open Space and Promenade and Soccer Pitch	Sufficient and safe pedestrian walkways will be provided during construction. Soccer Pitch will be closed during construction work, but the closing time will take into consideration the schedule of major functions to be held.

Works Items	Impact on the surrounding environment
Area 4: Beautification of the area around Shui Sin Temple (Sept. 2004 to July 2005)	
Beautification work	Not much noise will be generated.
Area 5: Improvement to the open space at Pat Kan Uk (Sept. 2004 to July 2005)	
Improvement to the open space at Pat Kan Uk	Not much noise will be generated.

Note 1: During construction period, hoarding will be erected to ensure public safety. Hoarding will be decorated with colour pictures. Transparent windows will also be provided on the hoarding so that visitors can enjoy the seaview.

Note 2: Pedestrianisation hours: 7p.m. to 11p.m. on Fridays, 11a.m. to 11p.m. on Saturdays, Sundays and Public Holidays

Note 3: The Southern District Council was consulted and supported the Redevelopment of Stanley Temporary Market by FEHD.

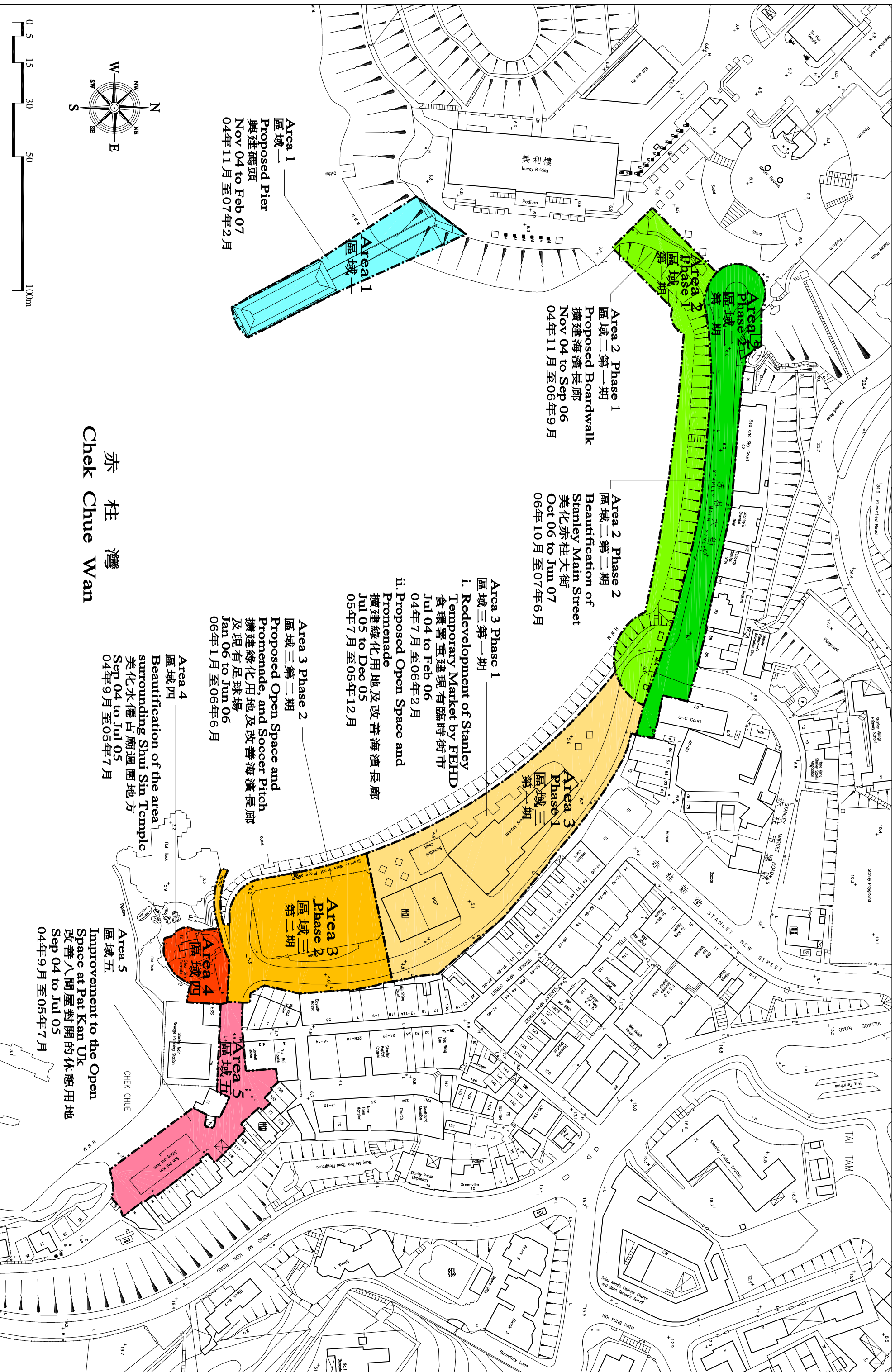

Area 1 區域一
Proposed Pier 興建碼頭
 Nov 04 to Feb 07
 04年11月至07年2月

Area 2 Phase 1 區域二 第一期
Proposed Boardwalk 擴建海濱長廊
 Nov 04 to Sep 06
 04年11月至06年9月

Area 2 Phase 2 區域二 第二期
Beautification of Stanley Main Street 美化赤柱大街
 Oct 06 to Jun 07
 06年10月至07年6月

Area 3 Phase 1 區域三 第一期
 i. Redevelopment of Stanley Temporary Market by FEHD 食環署重建現有臨時街市
 Jul 04 to Feb 06
 04年7月至06年2月
 ii. Proposed Open Space and Promenade 擴建綠化用地及改善海濱長廊
 Jul 05 to Dec 05
 05年7月至05年12月

Area 3 Phase 2 區域三 第二期
Proposed Open Space and Promenade, and Soccer Pitch 擴建綠化用地及改善海濱長廊及現有足球場
 Jan 06 to Jun 06
 06年1月至06年6月

Area 4 區域四
Beautification of the area surrounding Shui Sin Temple 美化水德古廟週圍地方
 Sep 04 to Jul 05
 04年9月至05年7月

Area 5 區域五
Improvement to the Open Space at Pat Kan Uk 改善八間屋對開的休憩用地
 Sep 04 to Jul 05
 04年9月至05年7月

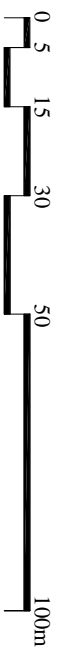
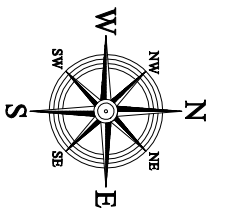

赤柱灣
 Chek Chue Wan

393RO Stanley Waterfront Improvement Project 赤柱海濱改善工程
Construction Phasing Plan 施工階段設計圖