

**Implementation of the Pilot Scheme for
Alfresco Dining along Sai Kung Hoi Pong Street**

Purpose

This paper aims to brief members on the arrangement of the implementation of the pilot scheme for alfresco dining or “outdoor seating accommodation” (OSA) for licensed restaurants at Sai Kung Hoi Pong Street.

Background

2. At present, Food and Environmental Hygiene Department (FEHD) is responsible for processing applications from restaurants providing OSA for the purpose of outdoor dining for the protection of public health and public safety. The licensees must obtain the legal right to use the space or land and demonstrate that the operations comply with the necessary food hygiene, road, fire and building safety requirements. Operators providing outdoor dining without approval may be subject to prosecution by FEHD and repeated convictions may lead to suspension or cancellation of the licences.

3. In view of the growing popularity of alfresco dining and the need for proper management, FEHD set up an inter-departmental working group to review the existing arrangements for outdoor dining. The working group considers that OSA appeals to both local and overseas tourists and adds colour to street landscape. The working group has recommended measures to ensure that the OSA is properly regulated and operated in an orderly and well-planned manner.

Pilot Scheme in Sai Kung

4. Sai Kung is a popular tourist district. It has a beautiful promenade commanding a magnificent seaview which provides a favourable place for alfresco dining. The District Office (Sai Kung) has recently completed the improvement works at Sai Kung Hoi Pong Street including erection of a Pai Lau and repaving the promenade beyond the Pai Lau. It is planned to launch the pilot scheme thereat in July 2002. The pilot scheme will last for six months and a review will be conducted at the end of the trial period.

5. Three restaurants along the section of Sai Kung Hoi Pong Street viz. Chuen Kee Restaurant, Kam Fai Restaurant and Fu Nga Restaurant will participate in the pilot scheme. Location plan of the restaurants is at Annex. In demarcating the boundary of OSA, matters including walkway for pedestrian flow, clearance of building exits and fire services installations / equipment, etc. have been considered. The daily operating hours of the pilot scheme will not extend beyond 11 p.m.

6. FEHD will monitor the implementation of alfresco dining during their normal routine patrol of the area. To facilitate control, the boundary of the OSA will be marked on site. The DO/SK will also maintain a close contact with the restaurants. The Police will be requested to step up crowd control and maintain order during the OSA operating hours. All the concerned departments will keep a close eye on the operation. If there is any breach of the licensing requirements or conditions, FEHD will issue warning letters. Repeated breaches would lead to withdrawal of the approval for OSA.

Tourism Commission
Economic Services Bureau
June 2002

Appendix
附件

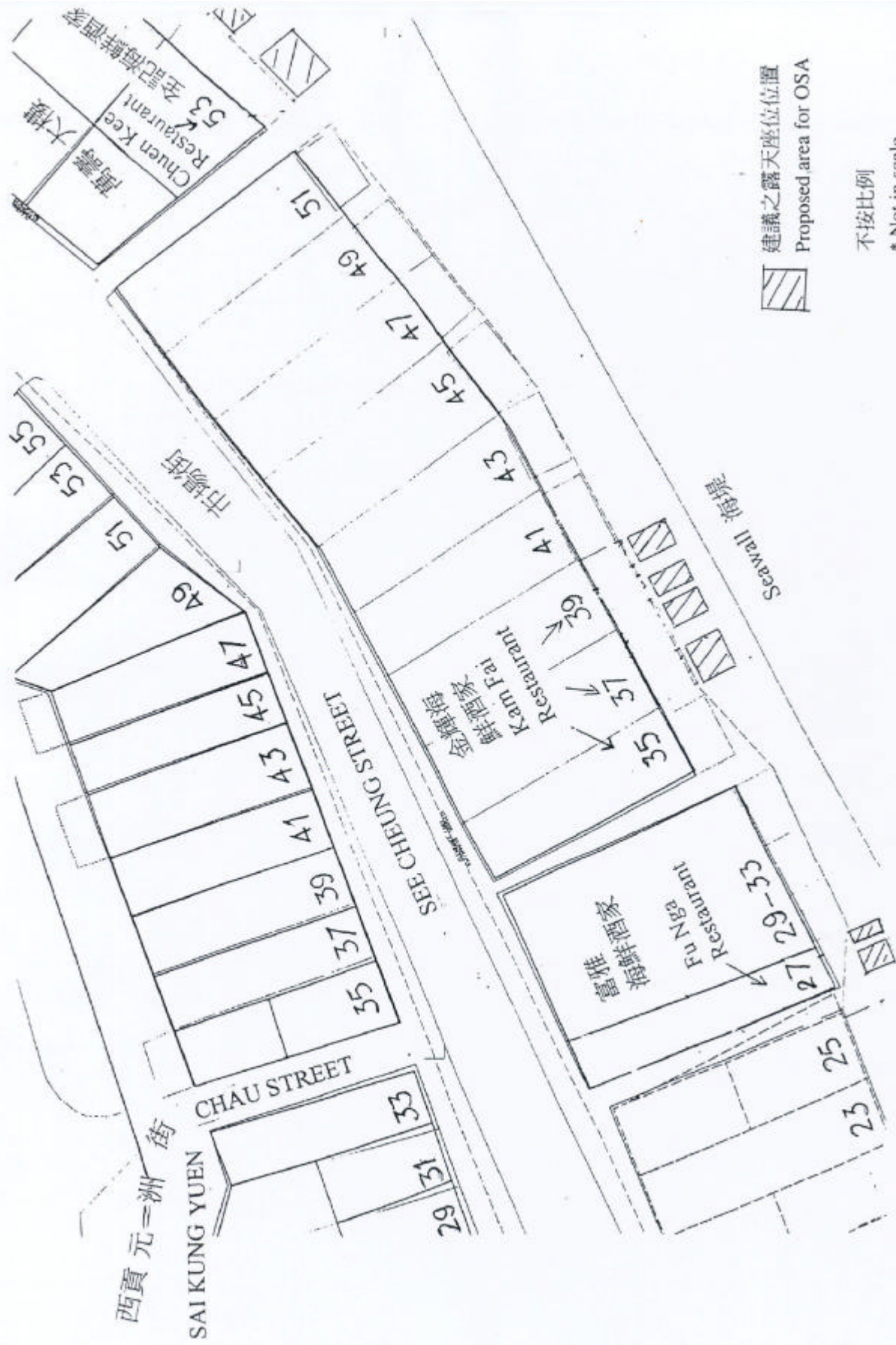

建議之露天座位位置
Proposed area for OSA

不按比例
* Not in scale